



PMDC ブラシモータ / PMDC Brush motor

IGモータ / IG motor

Series No. **SQ2953**

用途例/Application example

車載用バックドア開閉/Automotive trunk actuator



重さ/Weight :150g (Approx.)

寸法/Dimensions (mm)

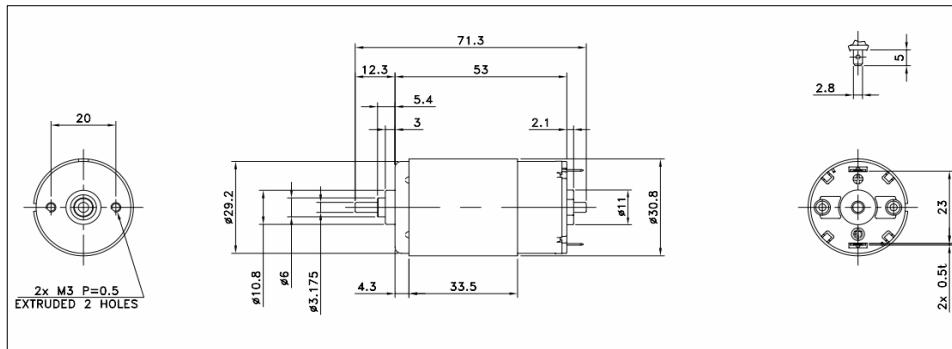

性能/Performance

Model Name	No load			Max Efficiency					Stall	
	Voltage	Speed	Current	Torque	Speed	Current	Output	Eff	Torque	Current
	V	rpm	A	mN-m	rpm	A	W	%	mN-m	A
SQ2953-034-GF-5	12.0	9760	0.32	20.81	8490	2.29	18.55	68	160.0	15.43

特性カーブ/Characteristic curves

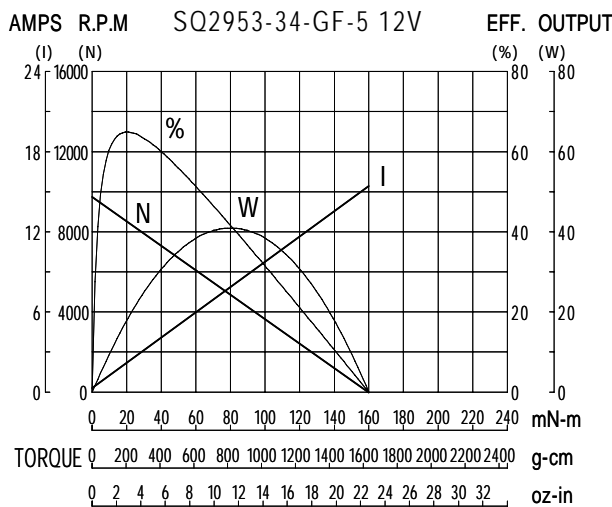

本カタログは、外形図、性能などの一部の例を掲載しております。お客様の御要望に応じ、巻線変更、などのご相談に応じております。  
The data shown in this catalog is reference purpose only. Customization to meet individual requirements is available.